

# Plug-in 70mm Type 3 SCDC Control Plate Assembly

## Parts List #4676

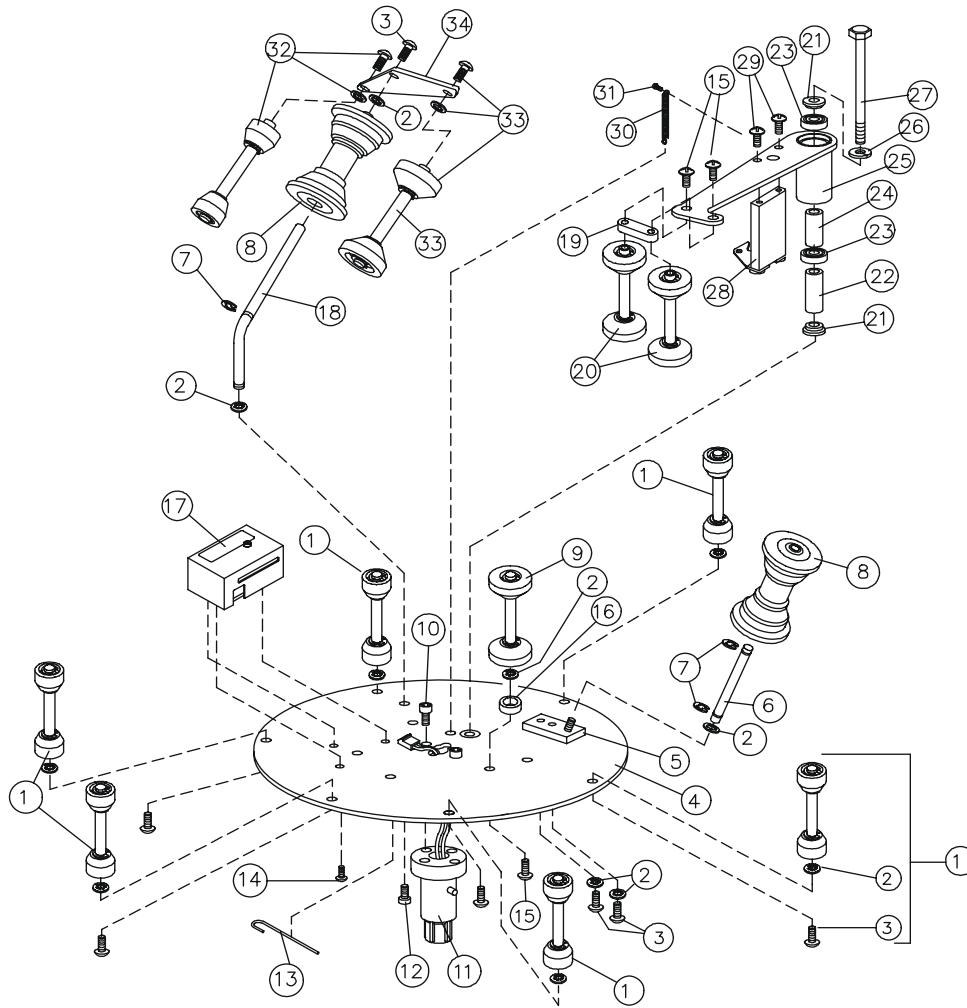

### **4719 CONTROL PLATE ASSEMBLY, PLUG-IN 70MM TYPE 3 SCDC**

1)	4705	Ctrl Plt Roller 70mm .75 (includes 2 & 3)	18)	1658	Ctrl Plt Exit Shaft #3, 5/16" Dia. 70mm
2)	1078	Lockwasher, #10, Internal Tooth	19)	4700	Control Plate Arm Spool Stop
3)	1071	Screw PTH, 10-32 x 3/8"	20)	4706	Control Plate Arm Roller 70mm
4)	2210	Ctrl Plt & Nut Sub Assy. Type 3 70mm	21)	2380	Control Plate Sensor Arm Washer
5)	5127	Control Plate Angle Block, Type 3 70mm	22)	1742	Control Plate Arm Hub Standoff, 70mm
6)	1654	Pulley Shaft-Castor, 5/16" Dia. 70mm	23)	2407	Bearing, 5/8 OD x 1/4 ID
7)	1050	E-Ring, 5/16"	24)	2379	Control Plate Sensor Arm Spacer
8)	4703	Pulley Sub-Assy. Type 3 70mm	25)	4715	Control Plate Arm & Hub Type 3 70mm
9)	4704	Control Plate Roller 70mm 1.06	26)	1079	Lockwasher, 1/4" Split Ring
10)	1064	SHCS, 8-32 x 3/8"	27)	3009	HHCS, 1/4-28 x 3 3/4"
11)	4364	Ctrl Plt, Plug-In Adapter, SCDC (Includes item 10)	28)	4677	Control Plate Standoff Assy, SCDC
12)	1592	SHCS, 10-32 x 1/2"	29)	1069	Screw, PTH, 8-32 x 3/8"
13)	2171	Phase Control Mask Spring	30)	3338	Control Plate Arm Return Spring, SCDC
14)	1910	Screw PPH 4-40 x 1/4"	31)	3353	SHCS, 2-56 x 1/4"
15)	1072	Screw, PTH, 10-32 x 1/2"	32)	4708	Control Plate Keeper Roller 70mm .75
16)	4301	Ctrl Plt Spool Spacer, Type 3 70mm	33)	4707	Control Plate Keeper Roller 1.06
17)	7261	SCDC Control USB Ctrl Plt (Incl item 14)	34)	1436	Control Plate Keeper Tab Type 3 70mm