

Portable Accumulator

Operation & Parts Manual #5192

Table of Contents

Overview.....	Page 2
Assembly.....	Page 2
Threading Diagram.....	Page 3
Maintenance.....	Page 3
Parts List.....	Pages 4 & 5

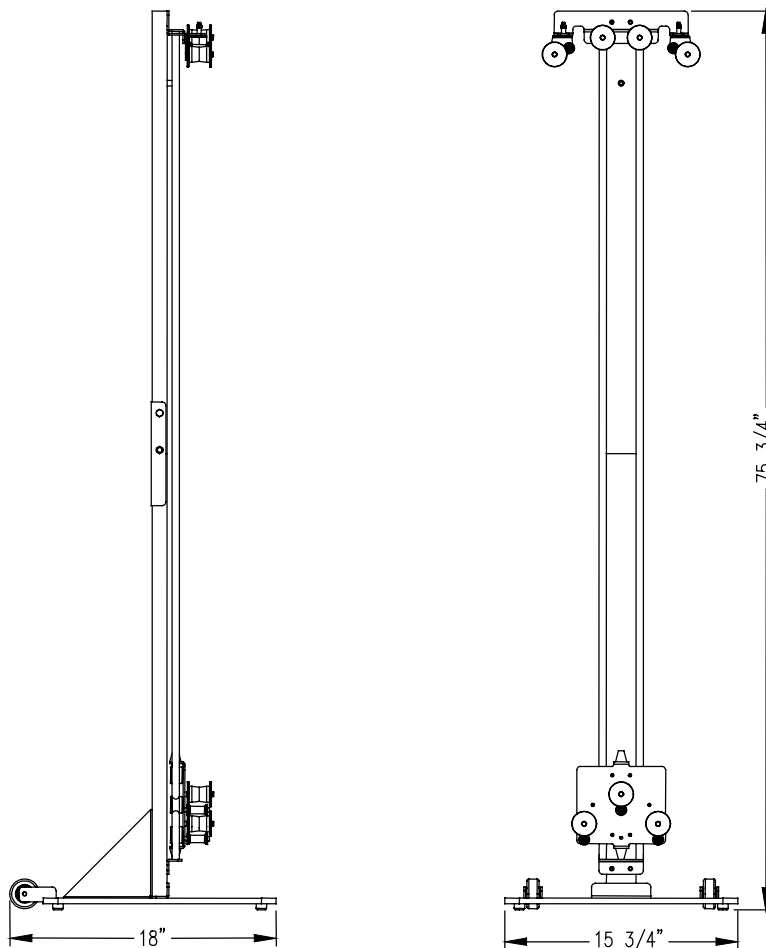

PORTABLE ACCUMULATOR
34.25 Feet of Film Accumulation
(18.5 seconds @ 90 ft/min.)
Weight: 45 pounds

OVERVIEW

The Portable Accumulator will accumulate 34.25 feet of film. Two self-adjusting casters allow the film to enter and exit the accumulator.

ASSEMBLY

1. Install the Column on the Base using two Hex Washer Head Screws. Do not tighten the screws. Install the Column Brace to the Column and Base using four more Hex Washer Head Screws. Tighten all six screws after the Brace is installed.
2. Install the Column Top in the Column Bottom and secure with two ¼-28 X 2 ½" Hex Capscrews.
3. Attach the 36" Rail Assemblies to the Bottom Bracket using the Internal Tooth Lockwashers and Phillips Trusshead Screws. Do not tighten the screws yet.

Note: The 36" Rail Assemblies are identified by the stud installed in one end.

4. Slide the Accumulator Slide Plate Assembly over the two 36" Rail Assemblies with the weight toward the Lower Bracket. Screw the two Upper Rails onto the 36" Rail Assemblies.
5. Install the Upper Bracket Assembly on the two assembled Rails and loosely secure with the Internal Tooth Lockwashers and Phillips Trusshead Screws provided.
6. Lay the assembled brackets, rails and slide plate on a flat surface. Move the slide plate until it contacts the lower bracket and tighten the screws in the lower bracket. Move the slide plate until it contacts the upper bracket and tighten the screws in the upper bracket. Move the Slide Plate through its travel and check for binding. If binding occurs, loosen the screws and adjust the rails. Install the accumulator assembly on the Column using the Hex Washer Head Screws provided. Install all three screws before tightening.

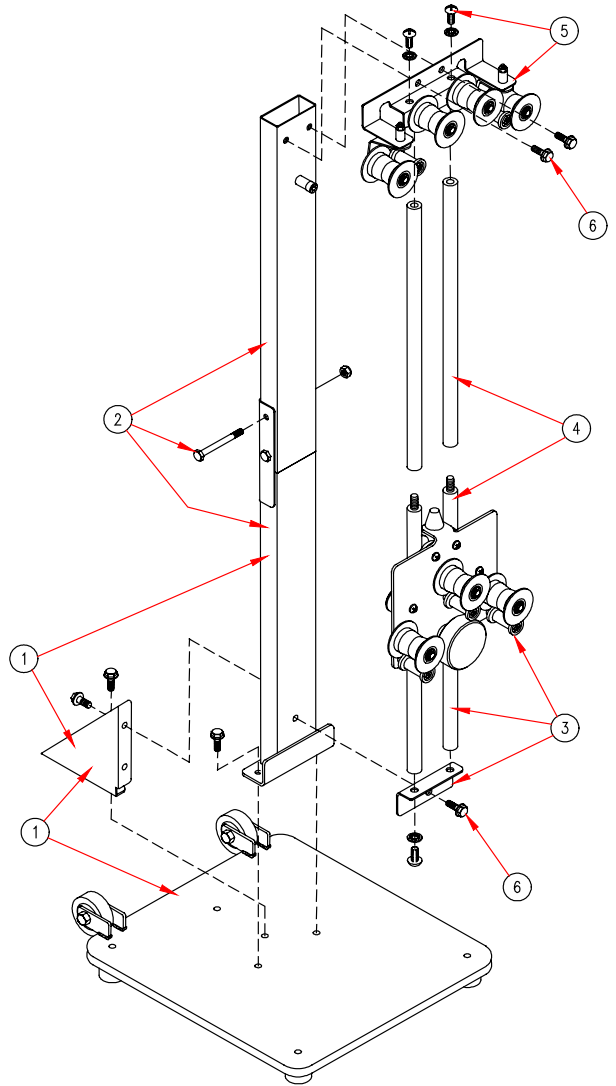

Figure 1

THREADING DIAGRAM

Thread the accumulator as shown in Figure 2. The self-adjusting casters will compensate for misalignment of film entering or exiting the accumulator.

MAINTENANCE

1. Keep the pulleys clean. Prevention of oil and lint build-up is important. Alcohol is a suitable agent for this purpose.
2. Check for loose pulleys, spools and fasteners and adjust the film path before running film.

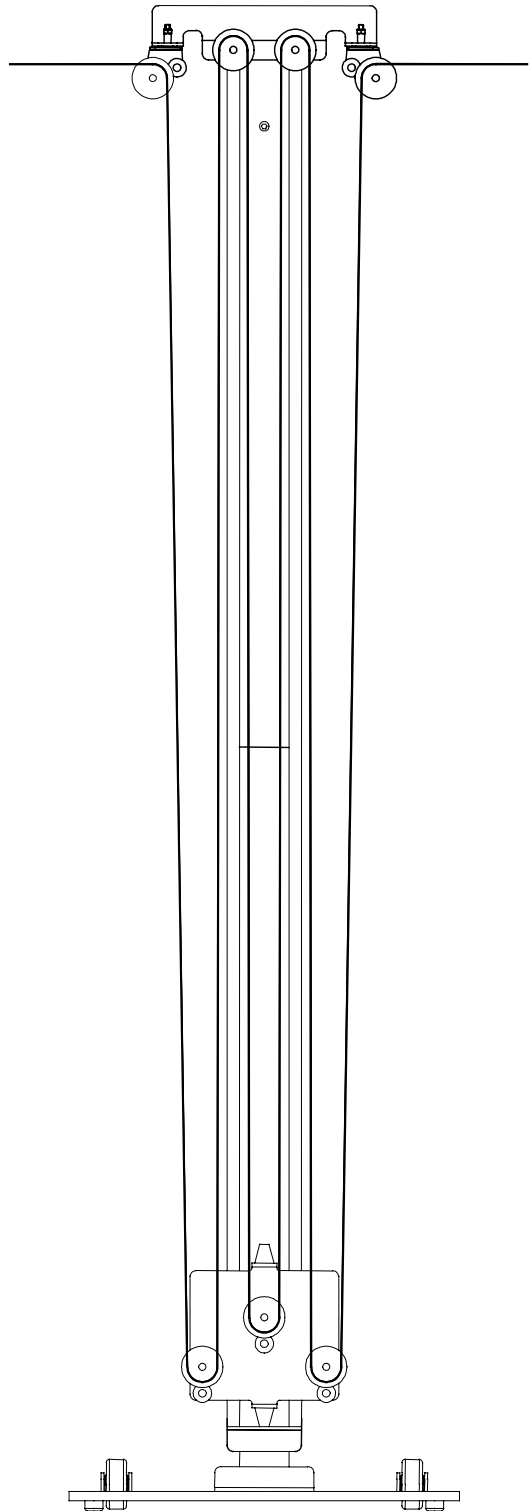
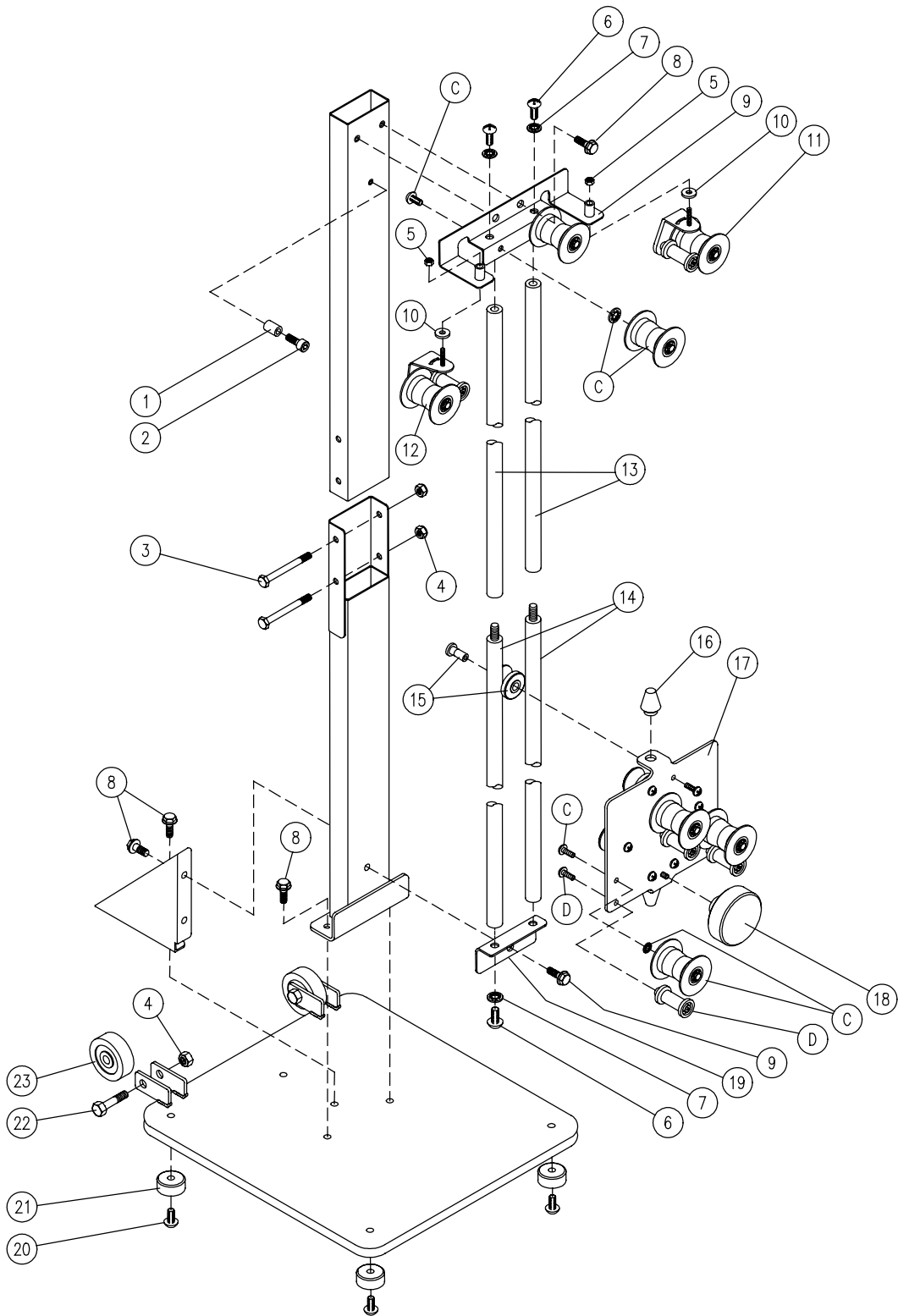

Figure 2

PORTABLE ACCUMULATOR PARTS

1	4344	Stop Bushing
2	1104	SHCS ¼-20 x 1
3	1095	HHCS ¼-28 x 2 1/2
4	1088	Hex Locknut Nylon ¼-28
5	2449	Locknut Nylon Insert 10-32
6	1071	Screw PTH 10-32 x 3/8
7	1078	Lockwasher #10 Internal Thread
8	2367	Hex Washerhead Screw ¼-20 x 5/8
9	7146	Upper Bracket Assembly (includes items 5,10,11 & 12)
10	2450	Flatwasher, Nylon .437 OD x .196 ID x .062
11	3646	Swivel Sub-Assembly, Left 35mm
12	3645	Swivel Sub-Assembly, Right 35mm
13	2627	Rail 36" Upper
14	7143	Rail Assembly 36"
15	2629	Slide Shaft & Roller Assembly
16	2067	Bumper
17	5393	Slide Plate Assembly (includes items 15, 16, 17, 18, C & D)
18	1425	Removable Weight
19	7145	Lower Bracket
20	2376	Screw PRH #8-32 x ½"
21	4921	Rubber foot
22	1746	HHCS ¼-28 x 1 1/2
23	1285	Wheel
C	1447	Pulley Shaft #6 & Pulley Assembly, 35mm
D	2602	Keeper Shaft & Spool Assembly



PORTABLE ACCUMULATOR PARTS